

High Pressure 2 Way Ball Valves – BKH/SS Series - Full Bore



STAINLESS STEEL BALL VALVES

316 Stainless Steel

250 – 500 BAR Rated

Threaded Female BSP Parallel/NPT

Size BSP	Max Pressure BAR	Article no. BSP	Price £	Price €	Article no. NPT	Price £	Price €
1/8"	500	9901001	£139.00	€145.90			
1/4"	500	9901002	£94.90	€99.60	9901010	£112.20	€117.90
3/8"	500	9901003	£100.80	€105.90	9901011	£115.30	€121.10
1/2"	500	9901004	£110.80	€116.30	9901012	£115.30	€121.10
3/4"	315	9901005	£214.60	€225.30	9901013	£222.40	€233.50
3/4"	420	9901005H	£388.40	€407.80	9901013H	£398.80	€418.80
1"	315	9901006	£233.20	€244.90	9901014	£243.80	€256.00
1"	420	9901006H	£571.30	€599.80	9901014H	£740.90	€777.90
1 1/4"	315	9901007	£292.80	€307.40	9901015	£340.40	€357.40
1 1/2"	250	9901008	£378.50	€397.40	9901016	£365.60	€383.90

Also available on request
- with compression ends
DIN2353 for tube connection

Materials

Body	316 Stainless Steel
Stem	316 Stainless Steel (Polished)
Stem Seal	NITRIL (Others On Request)
Ball Seal	POM-MoS2 (Others On Request)
Temp. Range	-10 to +100°C

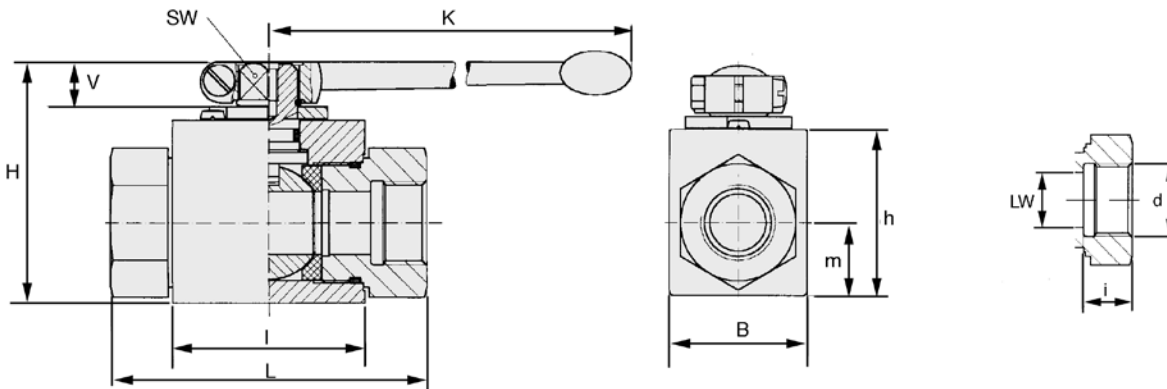

Dimensions (mm) Female Thread

Size	LW	L BSP	L NPT	I	B	H	h±0.5	m	V	SW	K	i	d	kg
1/8"	5	69	69	40	26	47	33	13,5	11	9	115	10	G1/8	0,41
1/4"	6	69	69	40	26	47	33	13,5	11	9	115	14	G1/4	0,40
3/8"	10	72	78	43	32	52	38	17,5	11	9	115	14	G3/8	0,54
1/2"	13	83	104	48	35	54	40	19	11	9	115	16,3	G1/2	0,65
3/4"	20	95	107	62	49	75	57	24,5	14	14	200	18	G3/4	1,5
3/4" *	20	107	102	82	58	83	65	32,5	14	14	200	18	G3/4	2,60
1"	25	113	119	66	58	83	65	29,5	14	14	200	20	G1	2,1
1" *	25	131	131	84	70	88	70	34,5	14	14	200	20	G1	4,0
1 1/4"	25	120	130	66	58	83	65	29,5	14	14	200	22	G1 1/4	2,51
1 1/2"	25	129	129	66	58	83	65	29,5	14	14	200	22	G1 1/2	2,70

* 420 BAR Rated

SUPPLIED ON REQUEST WITH TEST AND MATERIAL CERTIFICATE TO DIN50049-3.1b