



WARNING!

- GD series is not suitable for continuous or fast rotations.

Inline Swivel Adaptors

250 – 400 BAR Rated

The series GD swivel adaptors are designed to be mounted between a hose and a rigid component in order to allow and compensate occasional rotations, preventing hose damage.

Technical Features And Options

- Others threads available on request
- Working temperatures with standard seals: -20°C/ +110°C
- For AISI consider half of maximum static and rotation pressure

Materials

Construction material: Carbon steel.
 Standard seals: nitrile rubber
 Standard thread: BSP (GAS)
 Special materials on request: AISI 303, AISI 316, Brass
 Special seals on request: Viton, EPDM, Silicone
 Special thread on request: NPTF, Metric, UNF

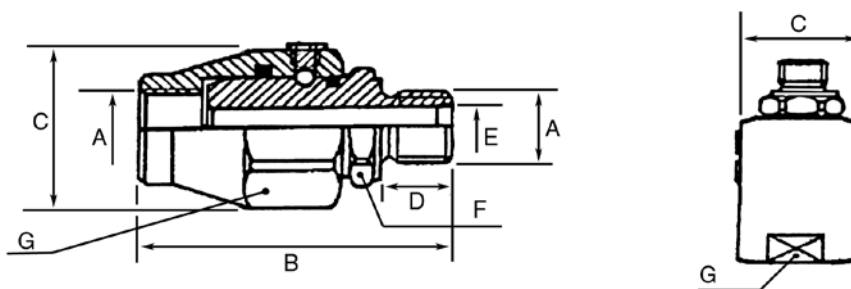

Dimensions (mm)

| A | B | C | D | E | F | G | Max pressure in rotation BAR | Static max pressure BAR | Article no. | Price £ | Price € |
|--------|-----|------|----|------|------|------|---------------------------------|----------------------------|------------------|----------------|----------------|
| 1/4" | 61 | 33 | 11 | 6,5 | ES19 | ES30 | 200 | 400 | 820400000 | £17.00 | €17.80 |
| 3/8" | 66 | 37 | 14 | 9,0 | ES24 | ES34 | 200 | 400 | 820400001 | £18.60 | €19.50 |
| 1/2" | 70 | 42 | 15 | 12,0 | ES27 | ES36 | 150 | 300 | 820400002 | £21.70 | €22.80 |
| 3/4" | 79 | 50 | 19 | 16,0 | ES34 | ES45 | 150 | 300 | 820400003 | £34.50 | €36.30 |
| 1" | 90 | Ø 55 | 21 | 20,0 | ES41 | CH50 | 100 | 300 | 820400004 | £48.40 | €50.80 |
| 1 1/4" | 101 | Ø 60 | 24 | 28,0 | ES50 | CH55 | 100 | 300 | 820400005 | £73.60 | €77.30 |
| 1 1/2" | 110 | Ø 70 | 25 | 34,0 | ES55 | CH65 | 80 | 300 | 820400006 | £112.00 | €117.60 |
| 2" | 118 | Ø 85 | 27 | 44,0 | ES65 | CH75 | 50 | 250 | 820400007 | £167.80 | €176.20 |



Stucchi®