

High Pressure 2 Way Ball Valves – BKH/SS Series - Full Bore

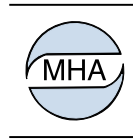

STAINLESS STEEL BALL VALVES

316 Stainless Steel

250 – 500 BAR Rated

Threaded Female BSP Parallel/NPT

Size BSP	Max Pressure BAR	Article no. BSP	Price £	Price €	Article no. NPT	Price £	Price €
1/8"	500	9901001	£161.10	€166.20			
1/4"	500	9901002	£110.00	€113.50	9901010	£133.80	€138.00
3/8"	500	9901003	£116.90	€120.60	9901011	£133.70	€137.80
1/2"	500	9901004	£128.40	€132.40	9901012	£133.70	€137.80
3/4"	350	9901005	£248.80	€256.60	9901013	£257.80	€265.80
3/4"	500	9901005H	£450.40	€464.40	9901013H	£621.30	€640.70
1"	350	9901006	£270.40	€278.90	9901014	£282.70	€291.50
1"	400	9901006H	£662.40	€683.10	9901014H	£859.00	€885.90
1 1/4"	315	9901007	£339.50	€350.10	9901015	£394.70	€407.00
1 1/2"	250	9901008	£438.90	€452.60	9901016	£423.90	€437.20

Also available on request
- with compression ends
DIN2353 for tube connection

Materials

Body	316 Stainless Steel
Stem	316 Stainless Steel (Polished)
Stem Seal	NITRIL (Others On Request)
Ball Seal	POM-MoS2 (Others On Request)
Temp. Range	-30 to +100°C

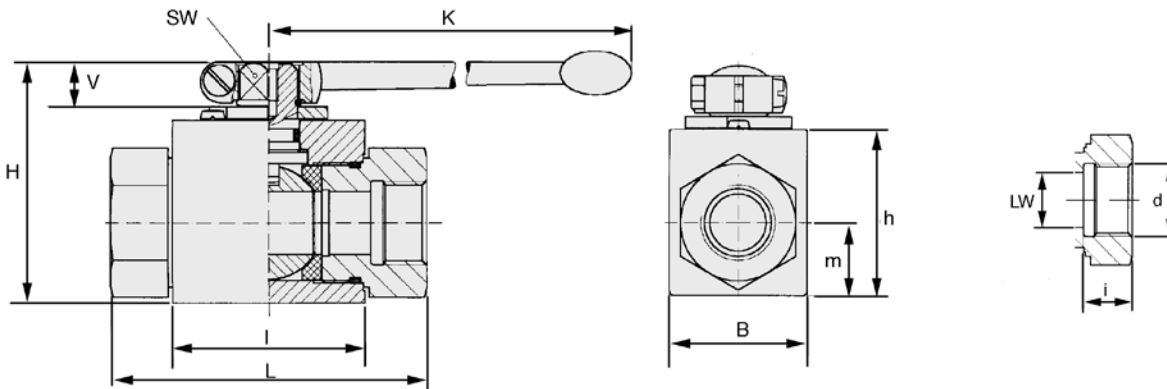

Dimensions (mm) Female Thread

Size	LW	L BSP	L NPT	I	B	H	h±0.5	m	V	SW	K	i	d	kg
1/8"	5	69	69	40	26	47	33	13,5	11	9	115	10	G1/8	0,41
1/4"	6	69	69	40	26	47	33	13,5	11	9	115	14	G1/4	0,40
3/8"	10	72	78	43	32	52	38	17,5	11	9	115	14	G3/8	0,54
1/2"	13	83	104	48	35	54	40	19	11	9	115	16,3	G1/2	0,65
3/4"	20	95	107	62	49	75	57	24,5	14	14	200	18	G3/4	1,5
3/4" *	20	107	102	82	58	83	65	32,5	14	14	200	18	G3/4	2,60
1"	25	113	119	66	58	83	65	29,5	14	14	200	20	G1	2,1
1" *	25	131	131	84	70	88	70	34,5	14	14	200	20	G1	4,0
1 1/4"	25	120	130	66	58	83	65	29,5	14	14	200	22	G1 1/4	2,51
1 1/2"	25	129	129	66	58	83	65	29,5	14	14	200	22	G1 1/2	2,70

* 420 BAR Rated

SUPPLIED ON REQUEST WITH TEST AND MATERIAL CERTIFICATE TO DIN50049-3.1b