

Wafer Pattern SAE Flanged Ball Valve – KHZ

420 BAR

Article no.	Size	Price £	Price €
41618	1/2"	£220.40	€227.30
41619	3/4"	£278.80	€287.50
41620	1"	£371.40	€383.00
41621M12	1 1/4"	£384.50	€396.50
41621M14	1 1/4"	£769.00	€793.10
41622	1 1/2"	£520.60	€536.90
41623	2"	£658.30	€678.80

M14 DN3 - Fixing as standard
M12 - on request

Materials

- Body: Steel
- Ball: Steel
- Stem: Steel
- Ball seats: POM
- O-rings: NBR
- Tmax: -10°C / 100°C

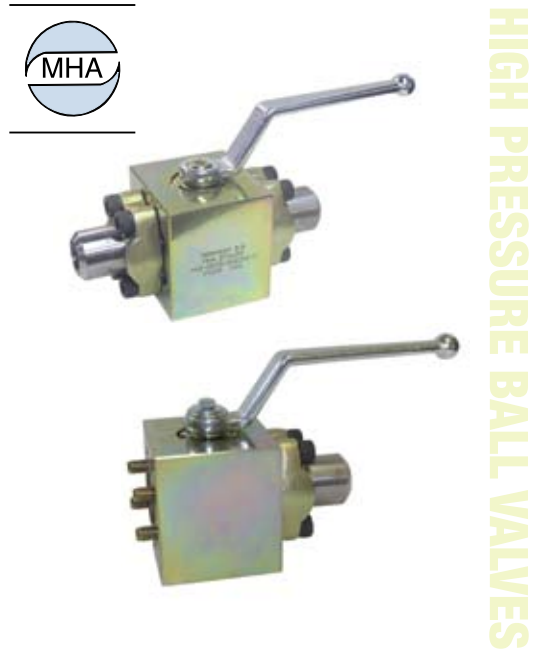

HIGH PRESSURE BALL VALVES

Dimensions

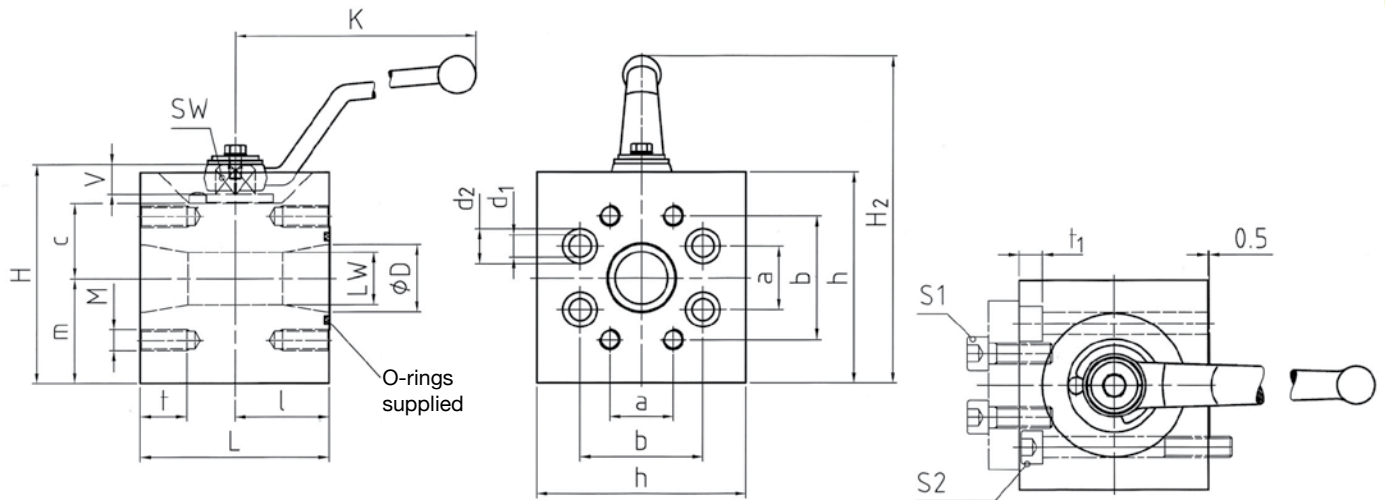

ISO 6162-1 420 BAR Please note the pressure ratings of the SAE-flanges!

Type	DN	LW	D	L	I	H	h	m	K	SW	V	a	b	M	t	d ₁	d ₂	t ₁	H ₂
KHZ-SAE420	13	13	13	68	34	72	58	30	115	9	11	18.2	40.5	M8	15	8.5	13.5	9	109
KHZ-SAE420	20	20	20	70	35	93	75	37.5	170	14	14	23.8	50.8	M10	17	10.5	16.5	11	146
KHZ-SAE420	25	25	25	78	39	103	84.5	44	170	14	14	27.8	57.2	M12	21	13	19	13	155
KHZ-SAE420	32	25	32	90	45	118.5	100	50	170	14	14	31.8	66.6	M14	20	13	19	13	171
KHZ-SAE420	40	32	38	99	49.5	141.5	120	60	306	17	17	36.5	79.3	M16	26	17	25	17.5	206
KHZ-SAE420	50	38	49	120	60	158.5	137.5	70	306	17	17	44.5	96.8	M20	34	21	31	21.5	223

Lever	Dimensions of screws S1 ⁽¹⁾ (min)	Dimensions of screws S2 ⁽¹⁾ (min)	O-ring	Weightkg
St	M8x30 - 10.9	M8x70 - 10.9	18.64x3.53	1.8
St	M10x35 - 10.9	M10x80 - 10.9	24.99x3.53	2.8
St	M12x45 - 10.9	M12x80 - 10.9	32.92x3.53	3.9
St	M12x45 - 10.9	M12x90 - 10.9	37.69x3.53	6.5
St	M16x55 - 10.9	M16x100 - 10.9	47.22x3.53	10.5
St	M20x70 - 10.9	M20x130 - 10.9	56.74x3.53	16.5

Flanges and fixing bolts are available on request

These products are not 'PED Compliant' for use with GAS
Should you have a GAS application please contact our sales office in order that they can check the PED requirements and offer a CE marked suitable product.